

EN

# HORI GAMING HEADSET PRO

for Nintendo Switch™

## Please read this manual before using.

Please retain manual for future reference.

## Overview

### Make sure that all cables are securely connected.

Please ensure that the notch on the mic is aligned properly when attaching.

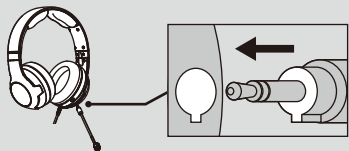

Please ensure that the mic is plugged in all the way for the mic to properly work.

Please ensure that the headset is securely plugged into the Nintendo Switch.

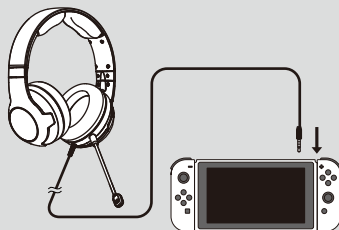

### Mic Orientation

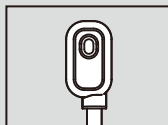
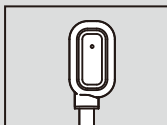
**Mic (Front)****Mic (Back)**

Make sure the front of the Mic is facing toward your mouth.

### Audio Jack

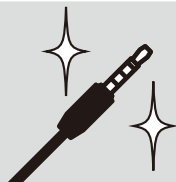

Please check if the plug is dirty as this may cause unwanted noise. If so, please wipe with a clean dry cloth.

# How to Connect

- Before connecting the headset to any device, be sure to turn down the volume on the Nintendo Switch and/or mobile device, as abrupt high volume may cause discomfort to your ears.
- Do not use high volume settings for an extended period of time to avoid hearing loss.

## When using with a game that does not support voice chat

### Necessary Items



Headset



Flexible Arm Mic



Mixer



Smart Phone/  
Mobile Device



Nintendo Switch

Some smart phones or mobile devices, such as an iPhone, may not be able to connect directly to the headset. In that case, a Headset Jack Adapter is needed. Please check your smart phone or mobile device manual for more information.

### Setup

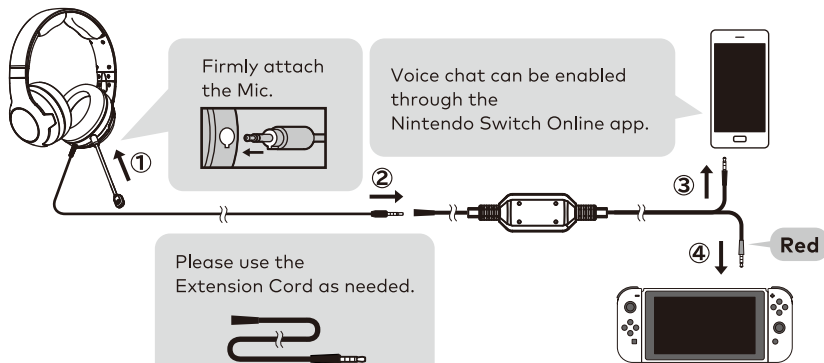

## Connecting to a game that supports Voice Chat

### Necessary Items



Headset



Flexible Arm Mic



Nintendo Switch

### Setup

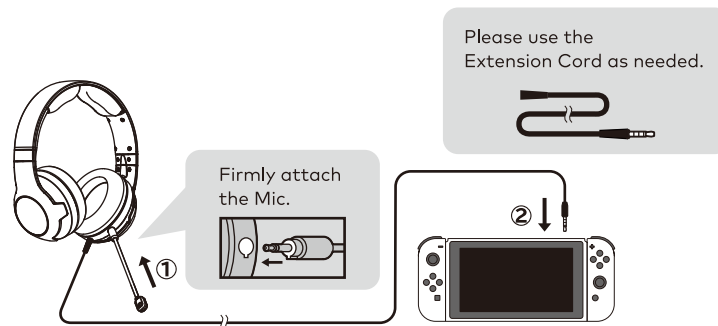

# Volume Control

## Adjust Audio on the Headset

Adjust the audio by turning the dial up or down.

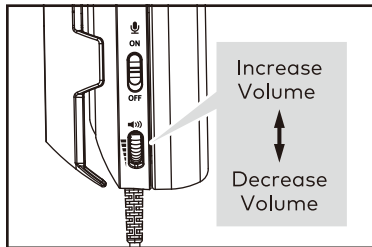

## Adjust Audio on the Nintendo Switch

Adjust the audio by pushing the Volume button.

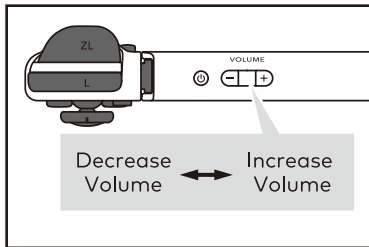

# How to use the Mic

The Mic Mute Button is on the back of the left Headphone

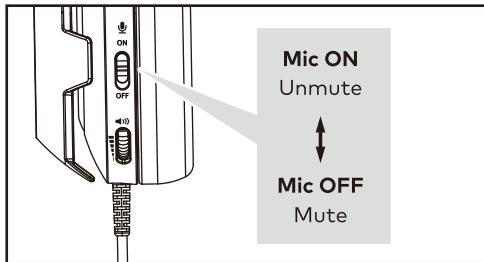

Please check the Mic.

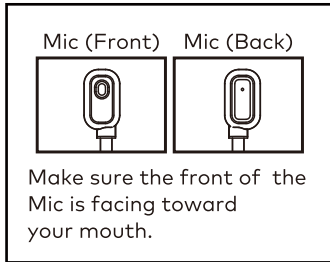

Please visit this website for more product information:

<https://stores.horiusa.com/gaming-headset-pro-for-nintendo-switch/>



### Simplified Declaration of Conformity

Hereby, Hori declares that this product is in compliance with Directive 2014/53/EU.

The full text of the EU declaration of conformity is available at the following internet address:

<https://hori.co.uk/consumer-information/>

For UK: Hereby, Hori declares that this product is in compliance with the relevant statutory requirements.

The full text of the declaration of conformity is available at the following internet address:

<https://hori.co.uk/consumer-information/>

This is not a wireless headset.

The image on the package may differ from the actual product.

The manufacturer reserves the right to change the product design or specifications without notice.

Nintendo Switch is a trademark of Nintendo. © 2021 Nintendo. Licensed by Nintendo.

HORI & HORI logo are registered trademarks of HORI.

All other trademarks are the property of their respective owners.

**Ages 6+**